

TECHNICAL SPECIFICATION										
MODEL	OPENINGS	VOLUME (Ltrs.)	DOME VOLUME (Ltrs.)	DIMENSIONS (mm)					BASE	WEIGHT OF VESSEL WITH BASE (Kg)
				"D1"	"D"	"H" ± 10	"L"	"F"		
24X65	4" TOP AND BOTTOM	423.4	61.6	615	610	1916	245	150	Tri-pod	38.2
24X72	4" TOP AND BOTTOM	478.2	61.6	615	610	2090	245	150	Tri-pod	42.3

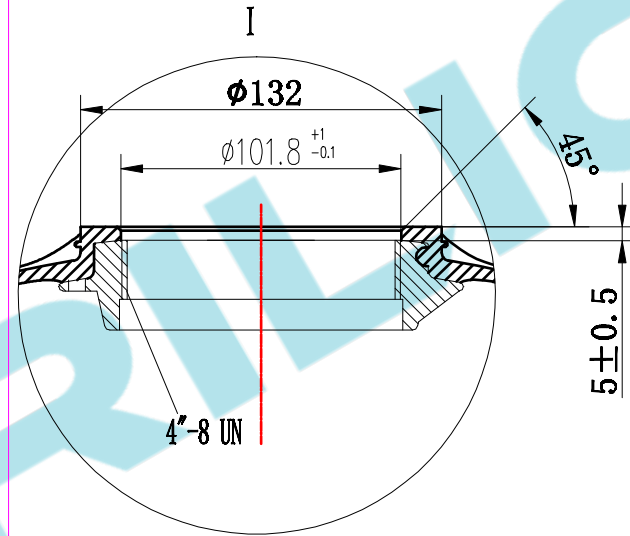

4"-8UN Internal Thread	
PITCH DIA	3.918-3.930"
MINOR DIA	3.865-3.875"
MAJOR DIA	4-4.010"

NOTES:	
1. TANK MUST MEET ALL APPLICABLE SPECIFICATIONS OF NSF/ANSI 044 STANDARD, LATEST REVISION.	
2. OPERATING SPECIFICATIONS:	
A. MAXIMUM WORKING PRESSURE:	10.5BAR(150PSI)
B. TEMPERATURE RANGE:	1-50°C (34-122°F)
C. MAXIMUM VACUUM:	17kpa (5" Hg)

SIGNATURE		SCALE 1: 8	MODEL: 24"(4" TOP AND BOTTOM)
NAME	DATE		
DESIGN		QUANTITY	DESCRIPTION FRP PRESSURE VESSEL
INSPECTION			
APPROVAL			
THIS DRAWING CAN NOT BE COPIED AND/OR USED WITHOUT PRIOR WRITTEN APPROVAL OF NOYI		PROJECTION	COMPUTER CODE
			DRAWING NO.
			VERSION NO.
		DO NOT MEASURE THE DIMENSIONS.	NY-TE-DR-SA-IEV-24
			1.4
			TOTAL PAGE: 1 OF 1